

Air Purifier WDH-H3 / WDH-H6



Dear Customer,

You have chosen a high-quality product. To ensure that you get a lot of enjoyment from this product, here are a few more tips:

In case of any problems:

We hope that the unit meets your expectations! If, despite the greatest possible care, there should ever be cause for complaint, please contact us briefly, as we are very concerned about your satisfaction and would like to clear up any misunderstanding.

Equipment and quality features:

Pre-filter: The cleanable pre-filter (filter grid plus filter foam) removes all larger particles such as coarse dust, hair and lint and ensures a longer service life of the HEPA filter.

Electrostatic filter block (ESP): Dust removal down to 0.1 micrometre and microbe-killing effect (bacteria, viruses and fungi) based on state-of-the-art electrostatic filtration (6 kV) ! The ESP filter block made of stainless steel is easy to clean and can be used again and again afterwards.

HEPA filter: One of the best filters around, this branded filter captures and filters particles as small as 0.0003mm. This includes pollen, germs, mould spores and dust with a purity rate of 99.97% !!!

Active carbon filter: Absorbs and cleans many types of smoke and odours (e.g. cigarette smoke) and also helps break down toxic fumes, gases and solvents.

Anion exchanger: Produces approx. 6-8 million anions/ions per second, which pro-actively combat smoke and other dirt particles in the room.

Air sensor operation (automatic mode): Automatically measures the air quality. If the detected air quality is very good, the air purifier automatically switches to a very low operating level (Low). If the result is the opposite and the air quality is inferior or poor, the operating strength adjusts automatically (Medium, High or Turbo).

Auto timer: With the timer, you can set/select a remaining running time of the appliance of up to 12 hours.

Touch panel: With this modern control panel, you can make your settings quickly and precisely.

3 speed levels: Strong, Medium and Weak

Night mode: Dimmed mode and very quiet operation.

LCD display: The air purifier has a modern and very clear LCD display, so you always have a quick overview of all settings. Furthermore, the current air quality and, if necessary, a filter change is signalled.

Metal housing: Very robust and with a high-quality and attractive design.

Child lock: Suitable to prevent unintentional adjustment of the settings.

Important safety instructions:

- Operate the unit only in a straight position and with a straight/level stand !
- Make sure that there is a minimum distance of 50 cm to the sides and a minimum distance of 10 cm to the rear of fixtures and walls!
- Do not place any objects on the appliance and make sure that the air intake and the exhaust air are always free!
- The appliance does not replace room ventilation and is not suitable for use as an extractor bonnet when cooking.
- Supervise the air purifier when children or animals are near the unit !
- This air purifier should only be operated by persons who have the necessary physical and mental capabilities to operate this device without problems !
- Watch out for electricity, never walk into or insert objects into the appliance !
- Only qualified personnel or electricians are allowed to open the inside of the unit !
- Protect the unit from all moisture and wetness !
- Only use the recommended voltage for operating the unit !
- Make sure that the power cable is unfolded (untied) before connecting it to the socket !
- Make sure that the plug is cleanly and properly connected to the socket before using the appliance !
- Do not expose the filters to insect spray, they could later release the insect spray unintentionally !
- Switch off the appliance and unplug the mains plug if you want to clean the appliance !
- Only clean the appliance with mild cleaning agents !
- Avoid using the unit at high room temperatures or in humid conditions !
- Do not make any independent modifications to the unit or the cables !
- Never reach near the plug or socket with wet hands !
- Make sure that highly flammable substances (e.g. gases/oils etc.) are never in the vicinity of the unit !
- If you are not going to use the unit for a long time, switch it off and disconnect the mains plug !

Please switch off the unit immediately and disconnect it from the mains/power supply if anything seems to be wrong !!! In this case, please contact a specialist and do not attempt to repair the unit yourself !!!

Examples: Fuse has blown or the appliance is making unusual noises and/or it smells burnt.

Device description:

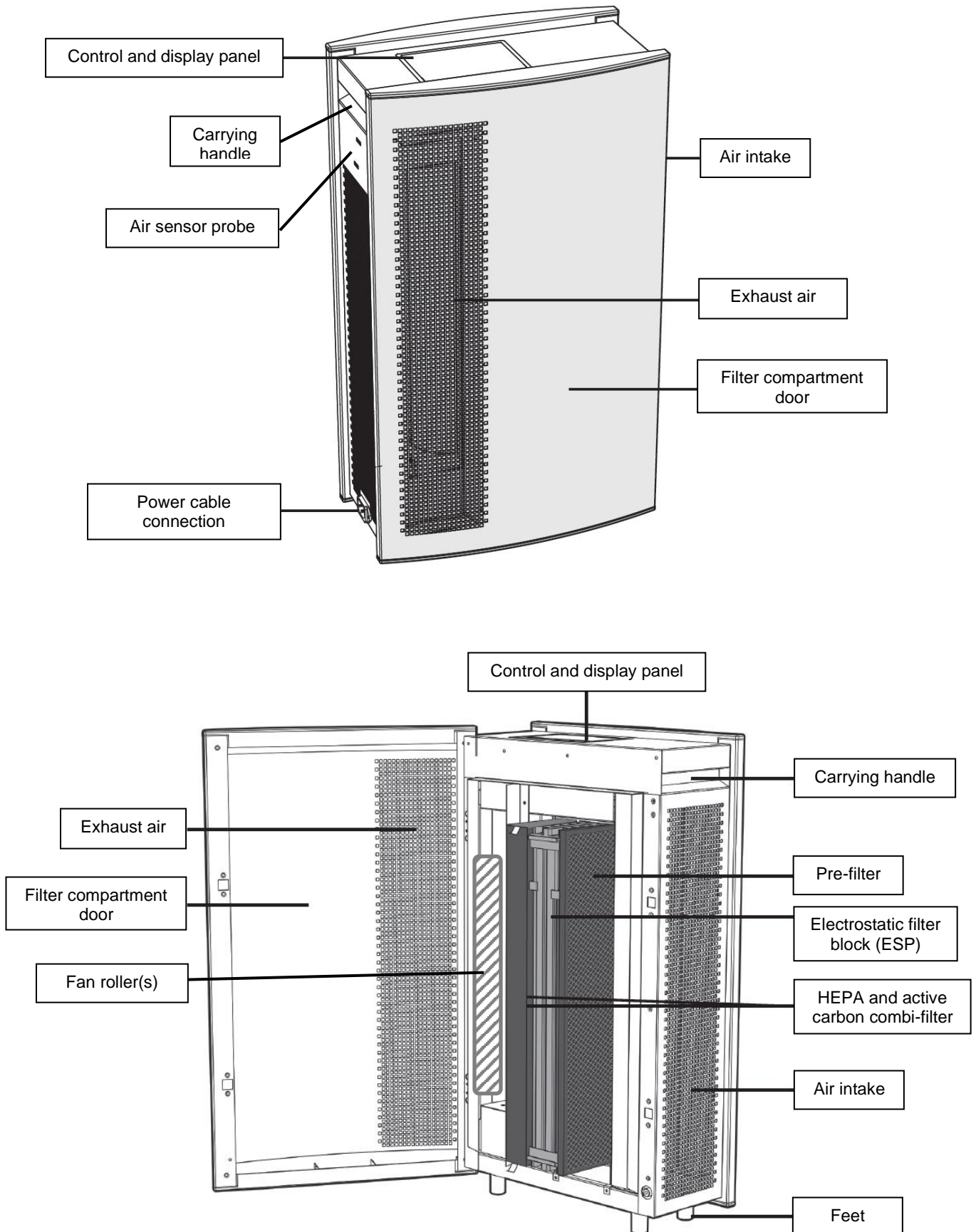

Instructions for use:

1.) Overview control panel:

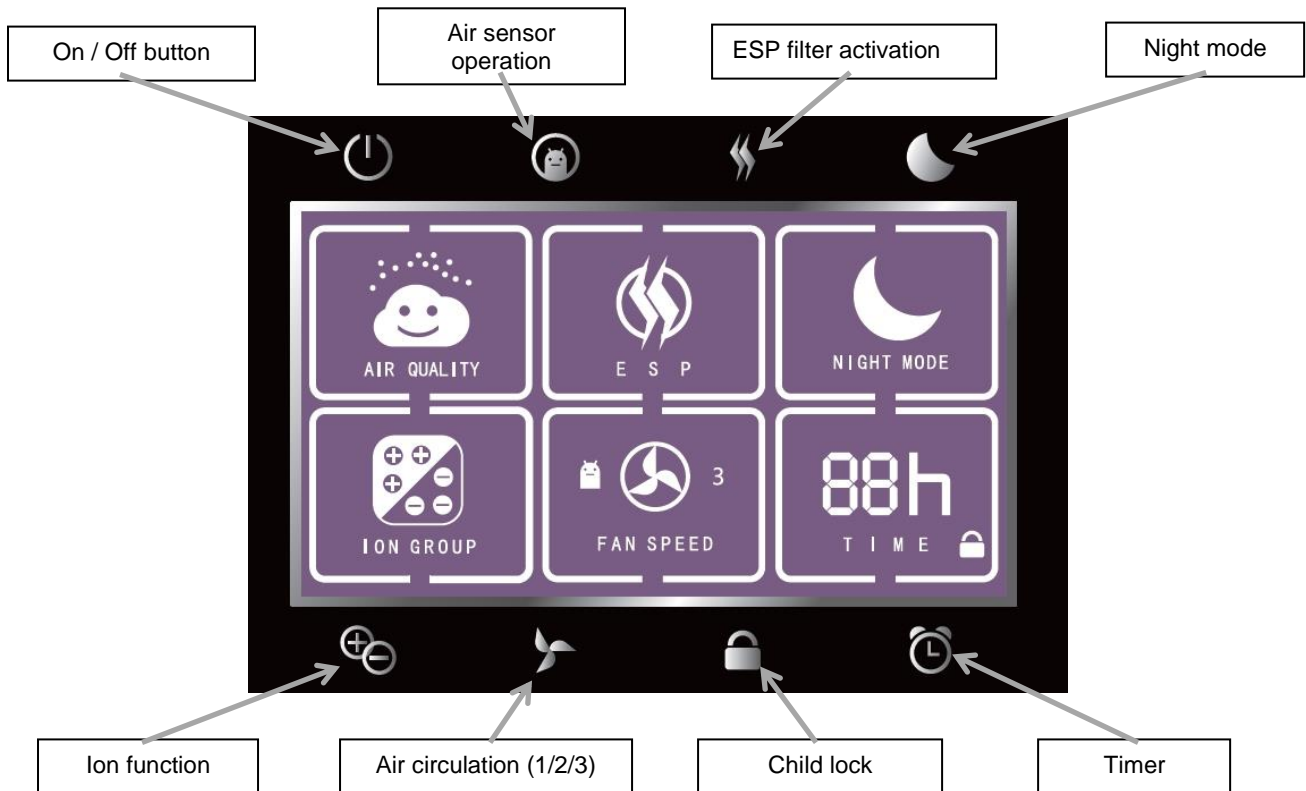

2.) Overview Display / Settings:



Display of the air quality (Air Quality)

There are three (3) different measurement results:

Cloud smiles=	air quality is good>	unit operates at low fan strength
Cloud is neutral=	air quality is polluted>	unit operates at medium fan speed
Cloud is sad=	air quality is poor>	unit operates at high fan speed



Electrostatic filter block (ESP):

The ESP filter can be activated (deactivated) by pressing the symbol . The ring then rotates clockwise and signals the active operation of the ESP filter.



Night operation

Night mode can be activated (deactivated) by pressing the symbol . The moon starts flashing and the rest of the display panel is dimmed. The air purifier now operates in minimum mode, i.e. very low-noise operation (low air circulation).



Anion exchanger / ion operation



Ion operation can be activated (deactivated) by pressing the symbol .



Display of the fan speed

There are three (3) different fan strengths, press the following button for this: 

Level 1 > Weak fan strength
Level 2 > Average fan strength
Level 3 > High fan power

When the  symbol lights up, automatic air sensor operation has been activated 



Time switch (timer)

You can select the following (remaining) running times of the air purifier by repeatedly pressing the timer button: 

1 h / 2 h / 4 h / 8 h / 12 h

After this time has elapsed, the air purifier switches off automatically. If the setting 00h has been selected, the unit runs in endless mode.

Note: The following key  can be used to activate the child lock of the appliance. Activation of the child lock is indicated by the symbol (lock) in the timer field. To cancel the child lock, keep the button pressed for 3 seconds or disconnect the appliance from the power supply for a short time.

3.) Preparation and installation of the filters

The air purifier is equipped with all filters from the factory. First open the front filter compartment door. Now remove all the filters. Remove the protective cover from the fine filters and then push the filters back into their drawers in the correct order. When inserting the filters, make sure that they are inserted the right way round. For the combi-filter (HEPA + activated charcoal filter) we recommend that the white HEPA side faces to the right so that the air flows through the HEPA filter first and only then through the activated charcoal filter. Finally, close the front filter compartment door again properly, otherwise the air purifier cannot be operated.

See the charts below:

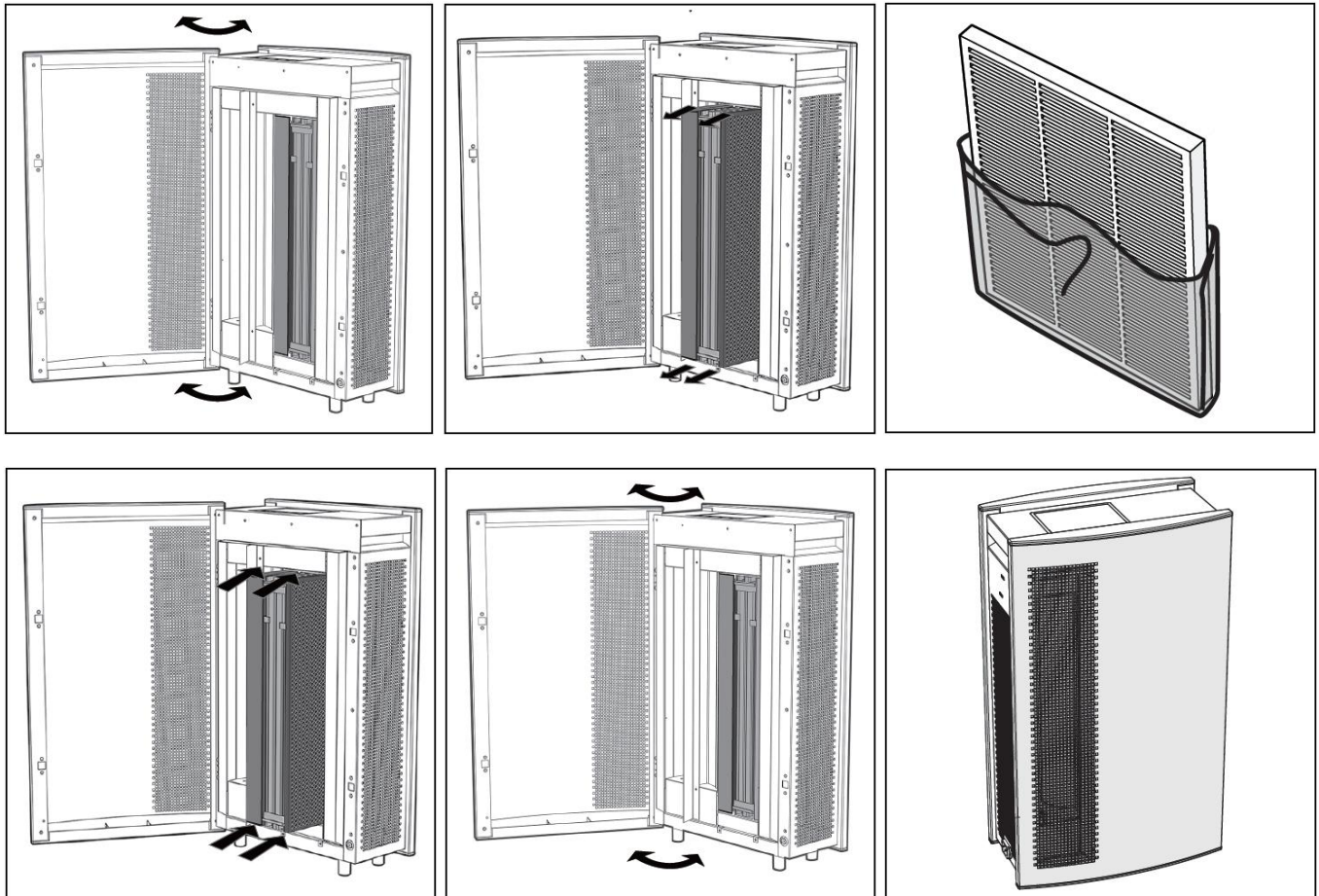

The filters (diagram):

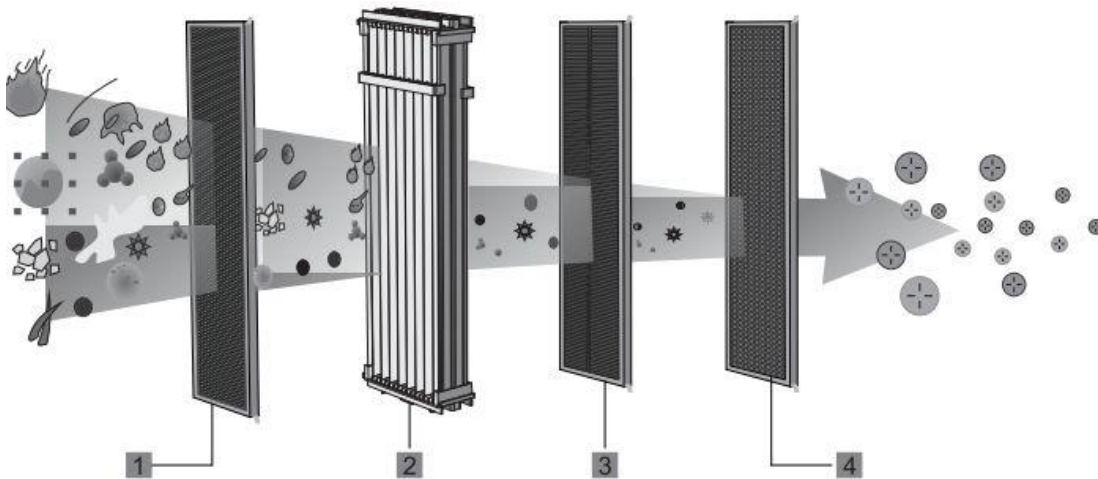

To achieve optimal filter results, we recommend the following filter sequence:

1. **Prefilter**
2. **Electrostatic filter block (ESP)**
3. **HEPA filter** (combined with the active carbon filter).
4. **Active carbon filter** (combined with the HEPA filter).

4.) The right location

Place the air purifier under the following aspects:

- Central to achieving the highest possible effectiveness.
- Near possible sources of dirt (windows, doors, pets, smokers).
- With a minimum distance to the side of 50 cm and to the rear of 10 cm.
- With a distance of approx. 100 cm to TVs, radios and similar devices.

5.) Power connection



First connect the supplied power cable properly to the air purifier, then insert the plug into the socket and wait for the unit to emit a short acknowledgement tone.

6.) Notes on the control panel (touch panel)

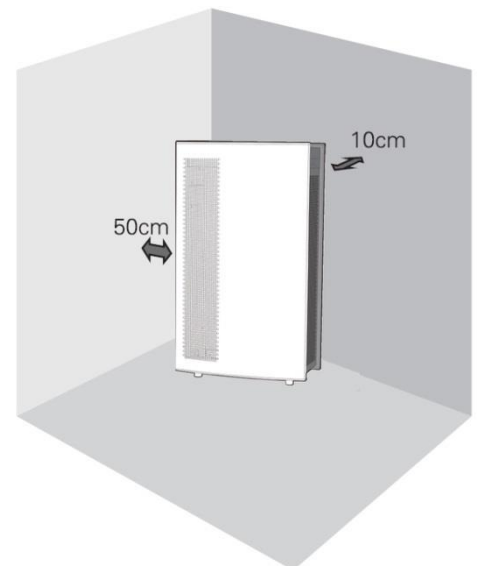
The control panel (touch panel) responds best to very short touches of the individual buttons. Longer touches and firm presses will cause the air purifier not to respond !

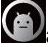

7.) Air sensor operation (automatic mode)

In addition to the air purifier settings as explained previously in point 2, the air purifier also has an automatic air sensor mode (automatic mode). Press the button to activate (deactivate)  and the symbol appears in the fan strength display field. 
Please note that the proper air sensor function is only available after approx. one minute !
If the determined air quality is "good", the air purifier automatically switches to a weak fan speed. If the result is the opposite and the air quality is inferior or poor, the air purifier switches to a stronger fan speed (medium or strong).

Operating instructions for automatic air sensor operation:

The air sensor is located on the side of the unit and reacts to particles in the air and thus always gives only a tendency of the air quality. Since it is a tendency (similar to a weather station), this function cannot provide a 100% reliable statement about pollutants in the room air or about the entire area of a room.
Furthermore, stronger operating fluctuations may occur from time to time (jump from good to bad and vice versa), as the air sensor probe reacts to different particles in the room and is also exposed to draughts.

Cleaning the air sensor

We recommend cleaning the air sensor area approx. every 4-6 months to ensure trouble-free operation of the air sensor (automatic mode). To do this, take a small soft (damp) cotton rod or something similar (e.g. pipe cleaner) and carefully pass it through the air slots of the air sensor area (see the following diagrams). Afterwards, we recommend blowing again vigorously into the air slots of the air sensor area.

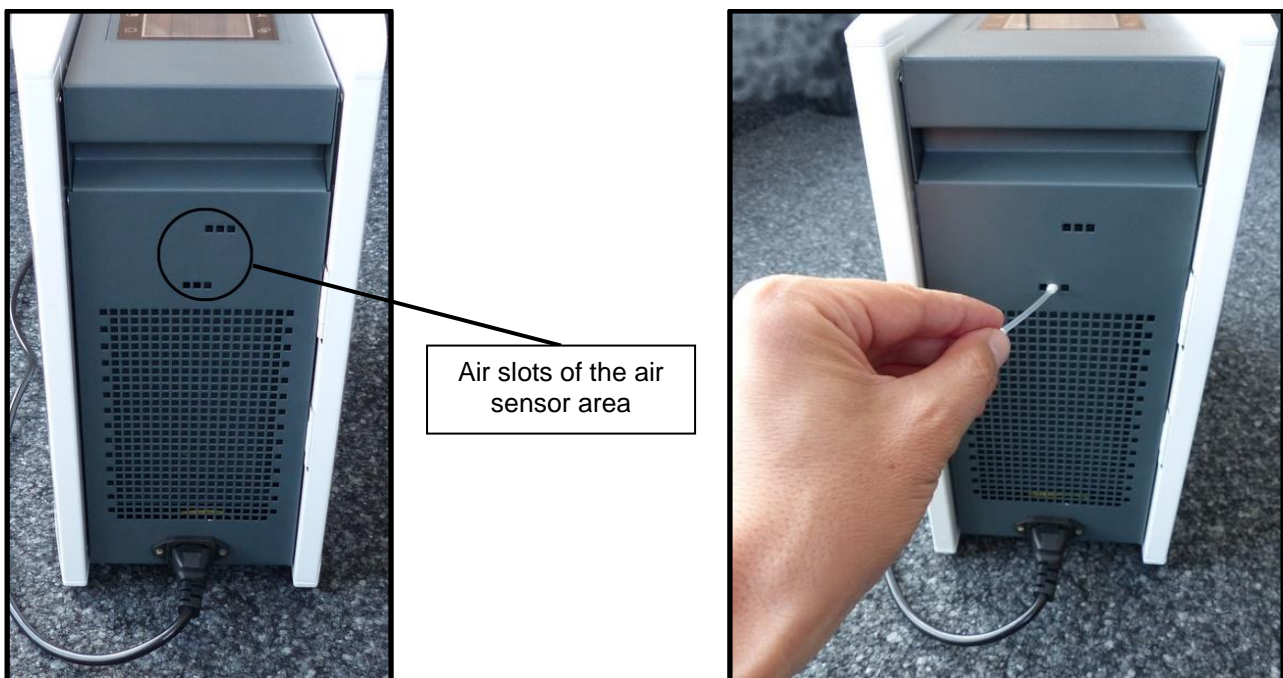

8.) Filter change / filter change indicator

The unit is equipped with a filter change indicator. Depending on the duration of use and the degree of soiling, this may be signalled to you by the indicator panel flashing ! This is the time when the pre-filter should be cleaned and/or the fine filters replaced.

Notes:

- Under normal conditions, the fine filters last for approx. 4,300 operating hours or up to 18 months with an operation of approx. 8 hours per day ! In more polluted rooms, e.g. smokers' households, the filters may have to be replaced after approx. 6 months (at the latest when the HEPA filter is dark brown, it should be replaced) !
- Disconnect the mains plug before cleaning/replacing the filters. For best filtration results, we strongly recommend that you use only original filters from the manufacturer.
- Never wash the fine filters. (Only the pre-filter and the ESP filter can be cleaned).

To change the filter, follow the instructions and diagrams as described earlier in the operating instructions under point 3.)

After the pre-filter has been cleaned and/or the fine filters have been replaced, it is necessary to reset the filter change indicator.

To do this, switch the air purifier on again and now press the On/Off button  permanently for approx. 3 seconds! The successful reset is signalled by a short acknowledgement tone. In addition, the flashing of the display field will stop again.

Cleaning the ESP filter block:

The ESP filter block made of stainless steel can be cleaned as follows.

- Carefully pull the ESP filter block out of the drawer like a honeycomb (touch the top and bottom).
- First remove the coarse dust and dirt with a Hoover.
- Then brush the fins of the ESP filter block with a soft brush.
- Again, remove any loose dust and dirt with a Hoover. Also remove any dust residue from the drawer itself.
- Now rinse the ESP filter block in a sink with the help of washing-up liquid and a soft brush (see illustration opposite).
- Allow the ESP filter block to dry completely.
- Finally, push the ESP filter block back into its drawer and close the filter compartment door properly.

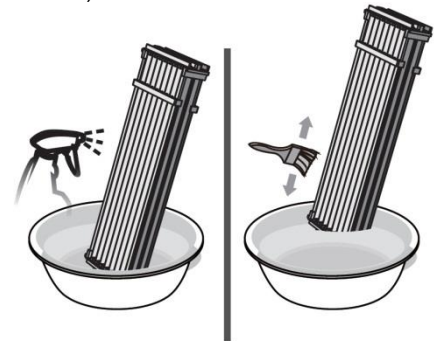

9.) Cleaning & Storage

Please always disconnect the mains plug first and allow the air purifier to drain completely before carrying out any cleaning activities on your unit !

9.1 Cleaning:

- Use a soft and damp cloth to clean the outside of the unit.
- Only use mild cleaning agents to clean your air purifier.
- Please ensure that water does not get into the interior of the unit or the electrical display panel (display) at any time !

9.2 Storage:

- We recommend covering the unit for storage or ideally packing it in its original box.
- Store the unit in a dry and sufficiently ventilated place/space.

Technical data:

Model designation:	<u>WDH-H3</u>	<u>WDH-H6</u>
Voltage:	220V ~ 50Hz	220V ~ 50Hz
Max. Power consumption:	25 W	45 W
Max. Air circulation:	150 m ³ /h	250 m ³ /h
Recommended max. room size:	30 m ² (75 m ³)	40 m ² (100 m ³)
Protection class:	IP20	IP20
Dimension (H/W/D):	345 x 352 x 204 mm	600 x 352 x 204 mm
Weight:	9.1 kg	13.5 kg

For the technical data, deviations are reserved !!!

Troubleshooting:

The unit itself emits an unpleasant odour:

A new air purifier still has a slight odour of its own (fresh plastic, new motor, new paint, etc.). This new smell dissipates within a very short time (1-2 weeks) !

The air sensor is causing problems:

Please read the notes under point 7 (Air Sensor Operation / Auto Mode). If the explanations given there are not applicable and the air sensor continues to cause difficulties (despite cleaning), read the following notes:

1. Check if the unit is in night mode. If so, deactivate the night mode.
2. Have you ever given the air purifier a "free hand" in "auto mode" for 12 hours or have you let it run continuously ? Especially at the beginning and especially with smokers, 12 hours of continuous operation and more are quite normal, because particles/odour patterns often sit in the entire inventory (curtains, upholstery, carpet, etc.) and depending on the nature of the material, it can take a considerable amount of time until these have been released again.
3. Please ensure that the air sensor function is not used when the air purifier is in a draught (e.g. between two open windows and/or doors).
4. In very rare cases, the air sensor may react negatively to certain substances (e.g. furniture polish, perfume, etc.) in your room. In these cases, you should refrain from using the automatic air sensor operation (Auto Mode).

It takes too long to neutralise smoke and/or odours:

In general, the air purifier is very well suited for odour and smoke neutralisation. However, please note that the result/end result of our air purifier always depends on how much odour particles are flowing in and how the air circulation is at your location! This is because the inserted odour filters always absorb/remove only a part of all odour particles in one pass. Therefore, a general rule is three filter passes until all odour particles have been absorbed.

(Note: When filtering dust and particles, one filter pass is sufficient to clean the air, as all particles are retained in the fine filter or by the ESP filter = 99% effectiveness. For odours, the active carbon filter is mainly used and here the filter medium needs approx. three filter cycles per cbm of air until one can speak of clean air = 33% effectiveness!)

Furthermore, it is important to consider that odour patterns may already be present in the furnishings - and depending on the nature of the individual materials, it may take a considerable amount of time for them to release the odours. (The air purifier only eliminates odours that are circulated or filtered through it).

The unit does not respond / The unit cannot be switched on:

1. Check the power cable. In particular, check the connection to the air purifier, because sometimes the power cable connection to the air purifier comes loose easily, which is why the air purifier is no longer supplied with power.
2. Check that all filters are properly inserted and that the front filter compartment door is properly closed.
3. Only touch the buttons on the control panel (touch panel) briefly. Prolonged touching and firm pressing will cause the air purifier not to respond !

The filter change indicator lights up or the control panel flashes, although the filters have been changed recently:

This can happen if the air purifier has not received enough supply air for a short time for some reason or if there has been a power failure.

1. Open the filter compartment door and check the filters or that they are properly seated.
2. Make sure that the air purifier has enough free space in the area of the air intake.
3. If everything is OK and the filters are not dirty, reset the unit by pressing the On/Off button continuously for approx. 3 seconds until you hear an acknowledgement tone. (The unit must be switched on during the reset!).

Other:

Warranty statement:

Notwithstanding the statutory warranty claims, the manufacturer grants a warranty in accordance with the laws of your country, but at least 1 year (in Germany 2 years for private individuals). The warranty begins on the date of sale of the appliance to the end user.

The guarantee only covers defects that are due to material or manufacturing faults.

Warranty repairs may only be carried out by an authorised customer service. To make a warranty claim, please enclose the original sales receipt (with date of sale).

Excluded from the guarantee are:

- Normal wear
- Improper applications, such as overloading the appliance or non-approved accessories.
- Damage due to external influences, use of force or foreign objects
- Damage caused by non-observance of the operating instructions, e.g. connection to an incorrect mains voltage or non-observance of the assembly instructions.
- Completely or partially dismantled units

Conformity:

The air purifier has been tested and itself and/or parts thereof have been manufactured under the following (safety) standards:

Of course with CE conformity.

CE (LVD) Conformity tested according to: EN 60335-2-65:2003+A1:2008+A11:2012
EN 60335-1:2012+A11:2014+A13:2017+A1:2019+A14:2019+A2:2019
EN 62233:2008

CE (EMC) conformity tested according to: EN 55014-1:2017
EN 55014-2:2015
EN IEC 61000-3-2:2019
EN 61000-3-3:2013+A1:2019

Correct disposal of this product:



Within the EU, this symbol indicates that this product should not be disposed of with household waste. Waste equipment contains valuable recyclable materials that should be recycled. Furthermore, the environment or human health should not be polluted by uncontrolled waste disposal. Therefore, please dispose of old appliances via suitable collection systems or send the appliance for disposal to the place where you purchased it. They will then recycle the appliance.



I wish you much pleasure with this appliance.

Your Aktobis AG

Keep these instructions for use in a safe place !

